

DE PRODUKTE  
FR PRODUITS

EN PRODUCTS  
ES PRODUCTOS

IT PRODOTTI

**A... / MOTOR**

**Fußbefestigung** / Foot mounting / Fissaggio piede /  
Fixation à pattes / Fijación por patas

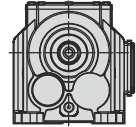
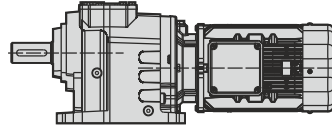

**A... / PAM**

**Fußbefestigung** / Foot mounting / Fissaggio piede /  
Fixation à pattes / Fijación por patas

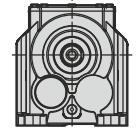
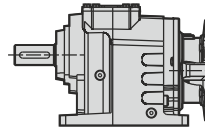

**A... / W**

**Fußbefestigung** / Foot mounting / Fissaggio piede /  
Fixation à pattes / Fijación por patas

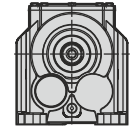
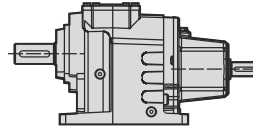

**F... / MOTOR**

**Flanschbefestigung** / Flange mounting / Fissaggio flangia /  
Fixation à bride / Fijación por brida

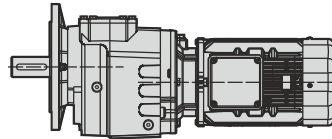

**F... / PAM**

**Flanschbefestigung** / Flange mounting / Fissaggio flangia /  
Fixation à bride / Fijación por brida

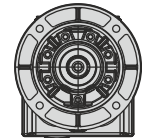
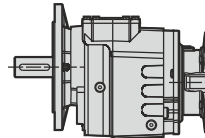

**F... / W**

**Flanschbefestigung** / Flange mounting / Fissaggio flangia /  
Fixation à bride / Fijación por brida

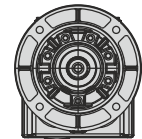
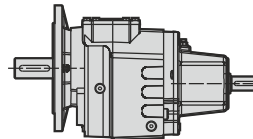

**AF... / MOTOR**

**Fuß-Flanschbefestigung** / Foot-flange mounting / Fissaggio piede-flangia  
Fixation à paaes et bride / Fijación patas-brida

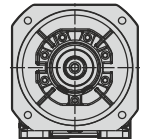
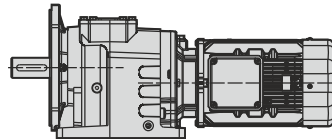

**AF... / PAM**

**Fuß-Flanschbefestigung** / Foot-flange mounting / Fissaggio piede-flangia  
Fixation à paaes et bride / Fijación patas-brida

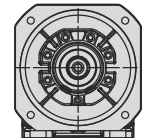
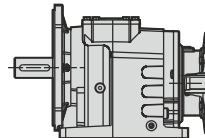

**AF... / W**

**Fuß-Flanschbefestigung** / Foot-flange mounting / Fissaggio piede-flangia  
Fixation à paaes et bride / Fijación patas-brida

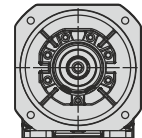
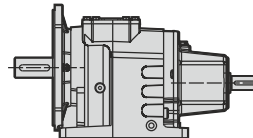

Typ / Type / Tipo Type / Tipo	l <sub>ges</sub>	4-pol 50Hz 1400rpm n <sub>2</sub> [min <sup>-1</sup> ]	M <sub>amax</sub> f <sub>B</sub> =1 4 - pol. [Nm]	W			IEC - PAM									
				P <sub>1max</sub> 4 - pol. 1400 rpm [kW]	FR1 [kN]	FR2 (a) [kN]	f <sub>B</sub> ⇨  49 - 112									
<b>A603</b> <b>F603</b> <b>W</b>  139 + <b>PAM - IEC</b>  139	242.67	5.8	3600	2.17	4.0	22.0	90	100*	112*	132*						
	215.56	6.5	3500	2.38	4.0	22.0	90	100*	112*	132*						
	194.31	7.2	3500	2.64	4.0	22.0	90	100*	112*	132*						
	181.13	7.7	3500	2.83	4.0	22.0	90	100*	112*	132*						
	139 160.90	8.7	3500	3.19	3.9	22.0	90	100	112*	132*						
	143.57	9.8	3500	3.57	3.9	22.0	90	100	112*	132*						
	<b>PAM - IEC</b>	134.25	10.4	3500	3.82	3.9	22.0		100	112*	132*	160*				
	121.02	11.6	3500	4.24	3.9	22.0		100	112*	132*	160*					
	139 100.21	14.0	3500	5.12	3.9	22.0		100	112	132*	160*					
	93.60	15.0	3500	5.48	3.8	22.0		100	112	132*	160*					
	84.37	16.6	3500	6.08	3.8	22.0		100	112	132*	160*					
	79.98	17.5	3500	6.42	3.8	22.0		100	112	132*	160*					
	69.87	20.0	3500	7.34	3.7	22.0		100	112	132*	160*					
	55.75	25.1	3500	9.20	3.7	22.0					132	160*				
	<b>A602</b> <b>F602</b> <b>W</b>  139 + <b>PAM - IEC</b>  139	50.91	27.5	3300	9.50	3.6	22.0	100	112	132						
45.27		30.9	3300	10.69	3.6	22.0	100	112	132	160*						
40.81		34.3	3300	11.85	3.5	21.7	100	112	132	160*						
38.00		36.8	2800	10.80	3.6	22.0	100	112	132							
139 33.79		41.4	3200	13.88	3.4	20.0	100	112	132	160*						
30.35		46.1	3200	15.46	3.4	18.9	100	112	132	160						
<b>PAM - IEC</b>		28.36	49.4	3300	17.06	3.3	17.8	100	112	132	160	180*				
25.57		54.8	3300	18.92	3.2	16.8	100	112	132	160	180*					
139 23.66		59.2	3300	20.45	3.1	16.1	100	112	132	160	180*					
21.17		66.1	3200	22.16	3.1	15.4	100	112	132	160	180					
19.59		71.5	3200	23.94	3.0	14.7	100	112	132	160	180					
17.60		79.5	3200	26.65	2.9	13.8	100	112	132	160	180					
15.87		88.2	3200	29.56	2.7	12.9	100	112	132	160	180					
13.14		106.5	3100	34.59	2.5	11.8	100	112	132	160	180					
10.91		128.3	3000	40.31	2.2	10.8			132	160	180					
9.83		142.4	2800	41.74	2.2	10.8			132	160	180					
8.14		171.9	2500	45.01	2.0	10.6			132	160	180					
6.92		202.4	2300	48.74	1.8	10.4			132	160	180					
6.24	224.5	2000	47.02	1.9	10.9			132	160	180						
5.16	271.1	1800	51.10	1.7	10.5			132	160	180						
<b>A601</b> <b>F601</b> <b>W</b>  136 + <b>PAM - IEC</b>  136	8.30	168.7	650	11.48	3.4	5.0	100	112	132	160*						
	7.45	187.8	650	12.78	3.4	5.0	100	112	132	160*						
	6.15	227.5	640	15.25	3.3	4.9	100	112	132	160						
	5.20	269.2	620	17.48	3.1	4.6	100	112	132	160	180*					
	136 4.81	290.9	620	18.89	3.1	4.4	100	112	132	160	180*					
	4.28	327.3	610	20.90	3.0	4.2			132	160	180*					
	<b>PAM - IEC</b>	3.65	383.6	600	24.10	2.8	3.9	100	112	132	160	180				
	3.23	433.8	600	27.25	2.7	3.7	100	112	132	160	180					
	136 2.44	572.7	550	32.98	2.4	3.4			132	160	180					
	2.00	700.0	450	32.98	2.4	3.3			132	160	180					
	1.38	1011.1	450	47.64	1.7	2.8			132	160	180					
1.27	1103.8	400	46.23	1.8	2.8			132	160	180						

- Keine IEC - PAM-Verbindung / No IEC - PAM assembling on empty fields / Nessun assemblaggio IEC - PAM su campi vuoti / Pas d'assemblage IEC - PAM sur champs vides / Sin montaje IEC - PAM en campos vacios
- 63 IEC - PAM-Verbindung möglich / IEC - PAM assembling available on numbered fields / Montaggio IEC - PAM disponibile su campi numerati / Assemblage IEC - PAM disponible sur champs numérotés / Assemblage IEC - PAM disponible sur champs numérotés /
- 80\* Bei IEC - PAM-Verbindungen, sollten die P<sub>1max</sub>-Werte nicht überschritten werden / Do not exceed the P<sub>1max</sub> values indicated on fields with asterisk / Non superare i valori P<sub>1max</sub> indicati sui campi con l'asterisco / Ne pas dépasser les valeurs P<sub>1max</sub> indiquées sur les champs avec astérisque / No exceda los valores de P<sub>1max</sub> indicados en los campos con asterisco

**A 601**

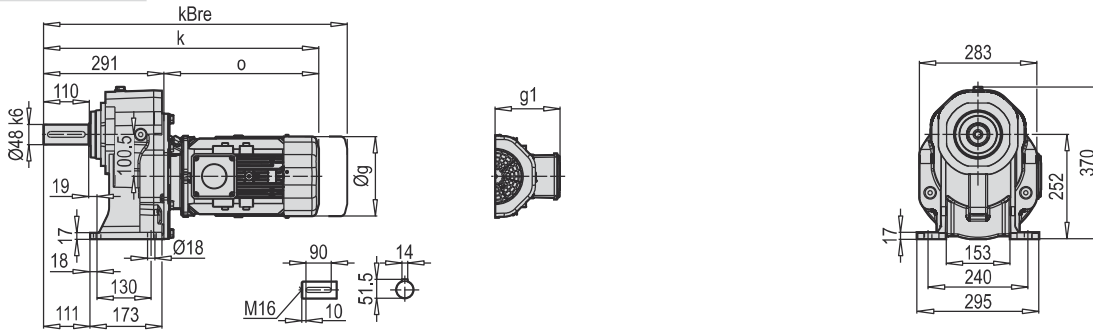

**AF-M 601**

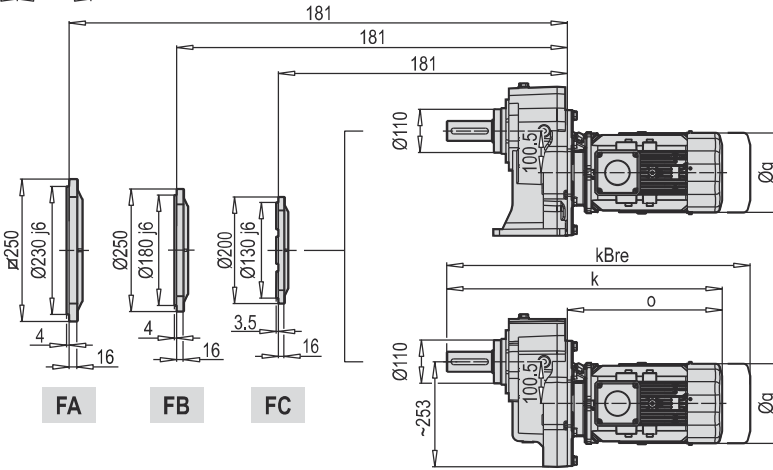
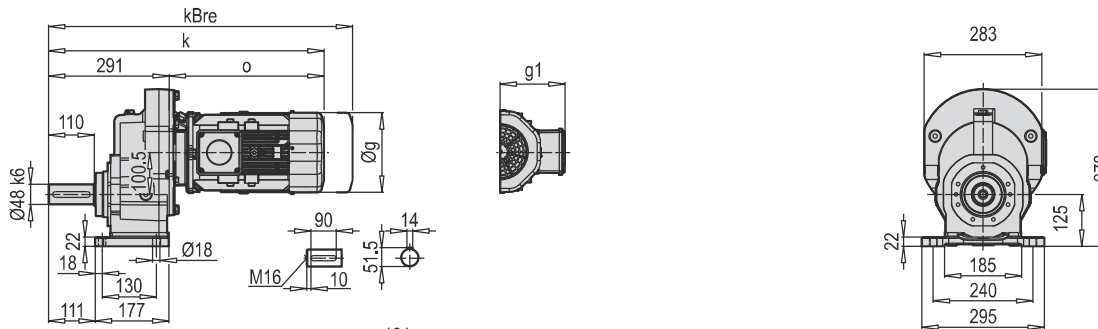

**AF 601**

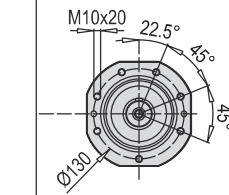

**F 601**

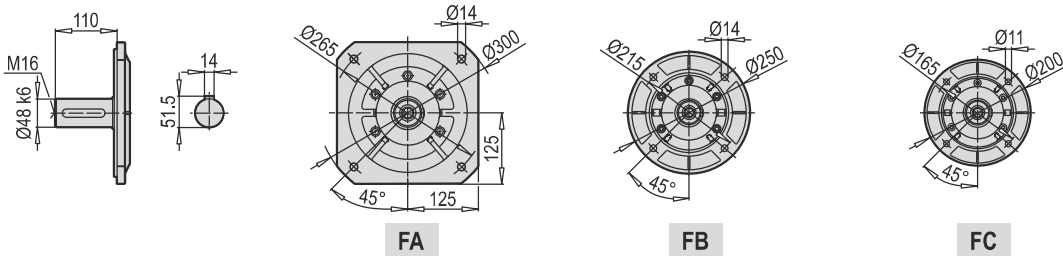

	112 M	132 S	132 M	160 M/L	180 M/L	200 L		
<b>g</b>	220	271	271	322	363	363		
<b>g1</b>	159	188	188	214	249	249		
<b>k</b>	662	735	735	816	906	906		
<b>kBre</b>	762	835	855	921	1025	1025		
<b>o</b>	371	444	444	525	615	615		

A 601 PAM B5/B14

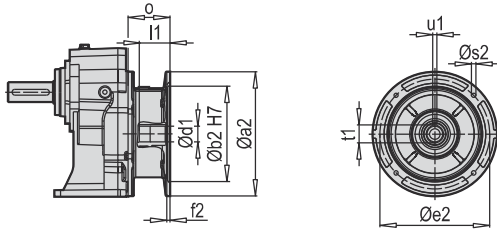

A 601 W

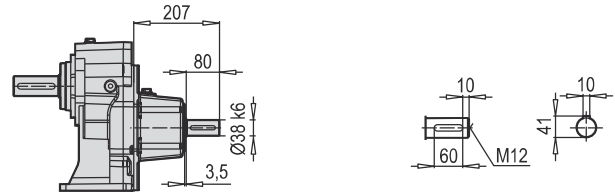

F 601 PAM B5/B14

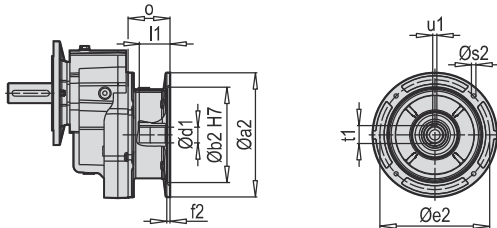

F 601 W

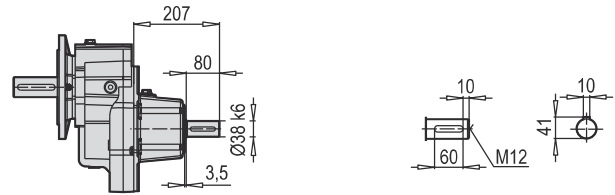

AF 601 PAM B5/B14

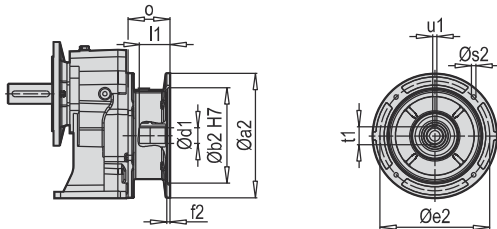

AF 601 W

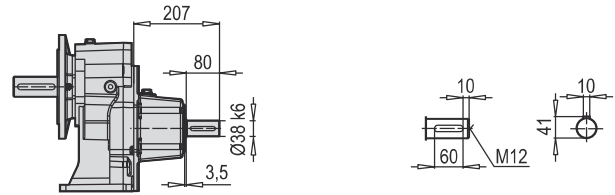

W ~ Kg	
A/F 601	45

AF-M 601 PAM B5/B14

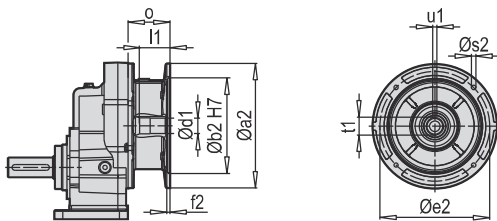

AF-M 601 W

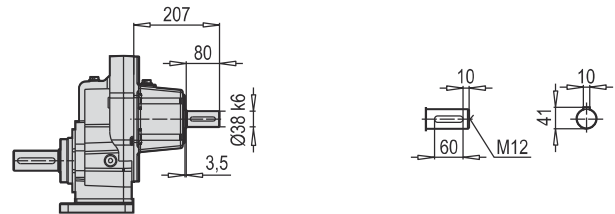

Typ / Type / Tipo Type / Tipo	PAM B5	Øa2	Øb2	Øe2	f2	Øs2	Ød1	l1	t1	u1	o
A/F 601	100	250	180	215	5.5	M12	28	62	31.3	8	76
	112	250	180	215	5.5	M12	28	62	31.3	8	76
	132	300	230	265	5.5	M12	38	82	41.3	10	101
	160	350	250	300	7	M16	42	112	45.3	12	148
	180	350	250	300	7	M16	48	112	51.8	14	148

Typ / Type / Tipo Type / Tipo	PAM B14	Øa2	Øb2	Øe2	f2	Øs2	Ød1	l1	t1	u1	o
A/F 601	100	160	110	130	3.5	9	28	62	31.3	8	76
	112	160	110	130	3.5	9	28	62	31.3	8	76
	132	200	130	165	3.5	11	38	82	41.3	10	101

~ Kg	
PAM B5	A/F 601
100	37
112	37
132	40
160	47
180	47

~ Kg	
PAM B14	A/F 601
100	34,5
112	34,5
132	38

DE ALLGEMEINE TEILELISTE

EN GENERAL PART LIST

IT GENERALE ELENCO DELLE PARTI

FR GÉNÉRALE LA LISTE DES PIÈCES

ES LISTE DE PIEZAS EN GENERAL

**A / F / AF / AFM 301 ... 701**

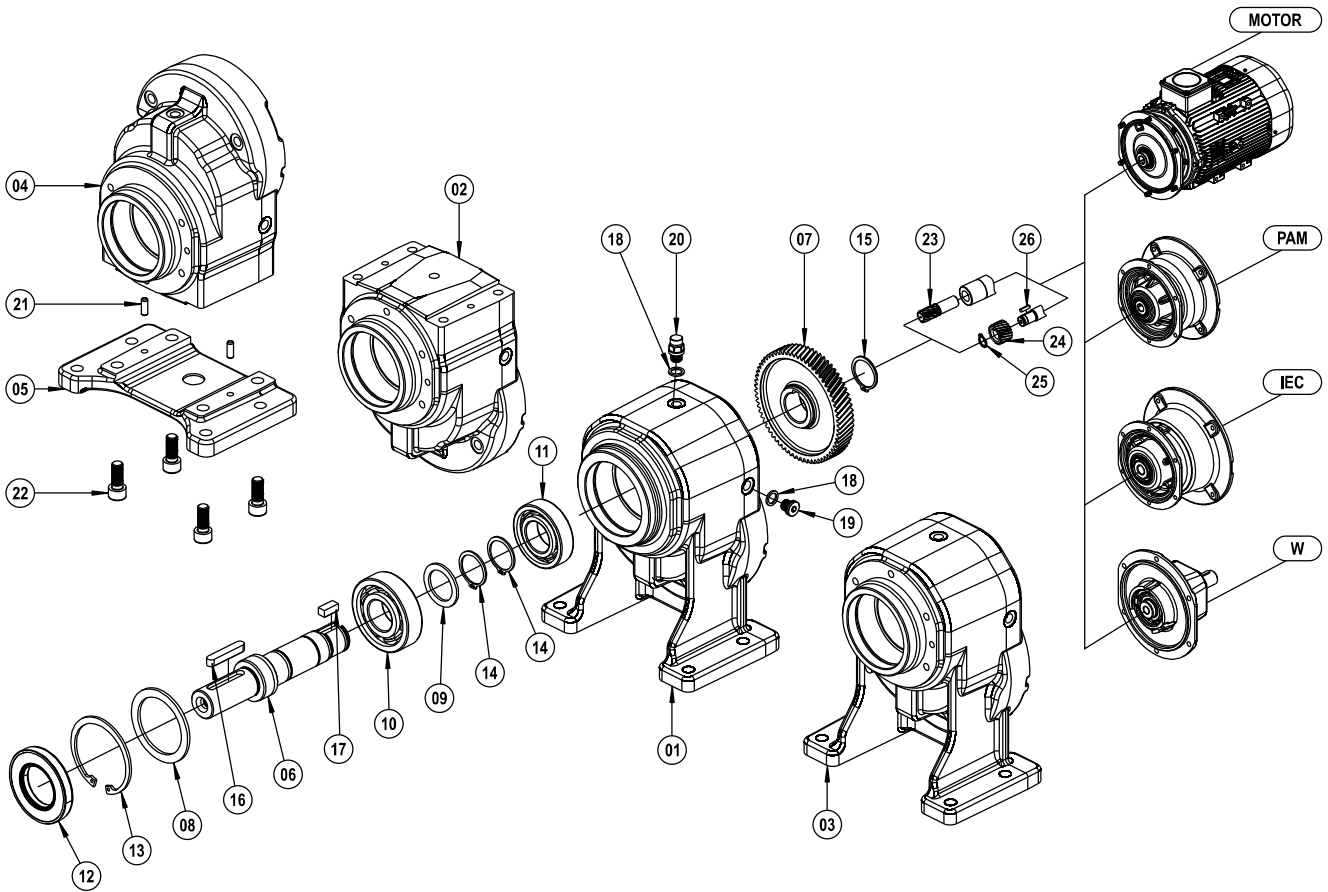

- |                                   |                           |                                  |                              |                               |
|-----------------------------------|---------------------------|----------------------------------|------------------------------|-------------------------------|
| 01 A Gehäuse                      | A Gear Case               | A Ingranaggi Box                 | A Corps                      | A La caja de engranajes       |
| 02 F Gehäuse                      | F Gear Case               | F Ingranaggi Box                 | F Corps                      | F La caja de engranajes       |
| 03 AF Gehäuse                     | AF Gear Case              | AF Ingranaggi Box                | AF Corps                     | AF La caja de engranajes      |
| 04 AF-F-M Gehäuse                 | AF-F-M Gear Case          | AF-F-M Ingranaggi Box            | AF-F-M Corps                 | AF-F-M La caja de engranajes  |
| 05 Fuss                           | Foot                      | Piede                            | Pied                         | Pie                           |
| 06 Abtriebswelle                  | Output Solid Shaft        | Albero di uscita                 | Arbre de sortie              | Eje de salida                 |
| 07 Antriebsrad                    | Driving Gear              | Ingranaggio Conduttore           | Rove d'entrée                | Engranaje con ducido          |
| 08 Distanzscheibe                 | Washer                    | Rondella                         | Rondelle                     | El apoyo a disco              |
| 09 Distanzscheibe                 | Washer                    | Rondella                         | Rondelle                     | El apoyo a disco              |
| 10 Kugellager                     | Bearing                   | Cuscinetto                       | Roulement à billes           | Rodamiento de bolas           |
| 11 Kugellager                     | Bearing                   | Cuscinetto                       | Roulement à billes           | Rodamiento de bolas           |
| 12 Öldichtung                     | Oil Seal                  | Paraolio                         | Joint Huile                  | Sello de aceite               |
| 13 Sicherungsring (DIN 472)       | Circlip (DIN 472)         | Anello di sicurezza (DIN 472)    | Circlip (DIN 472)            | Anillo de seguridad (DIN 472) |
| 14 Sicherungsring (DIN 472)       | Circlip (DIN 472)         | Anello di sicurezza (DIN 472)    | Circlip (DIN 471)            | Anillo de seguridad (DIN 472) |
| 15 Sicherungsring (DIN 471)       | Circlip (DIN 471)         | Anello di sicurezza (DIN 471)    | Circlip (DIN 471)            | Anillo de seguridad (DIN 471) |
| 16 Passfeder (DIN 6885)           | Key (DIN 6885)            | Chiavetta (DIN 6885)             | Clavette (DIN 6885)          | Clave (DIN 6885)              |
| 17 Passfeder (DIN 6885)           | Key (DIN 6885)            | Chiavetta (DIN 6885)             | Clavette (DIN 6885)          | Clave (DIN 6885)              |
| 18 Distanzscheibe (DIN 7603)      | Washer (DIN 7603)         | Rondella (DIN 7603)              | Rondelle (DIN 7603)          | El apoyo a disco (DIN 7603)   |
| 19 Ölstopfel (DIN 908)            | Oil Plug (DIN 908)        | Olio Tappo (DIN 908)             | Couverture d'huile           | Tapón                         |
| 20 Entlüftungstopfen              | Vent Plug                 | Tappo di sfianto                 | Bouchon d'huile (DIN 908)    | Ventilación (DIN 908)         |
| 21 Bolzen                         | Pin                       | Pin                              | Goupille                     | Pasador                       |
| 22 Verschrauben (DIN 912)         | Bolt (DIN 912)            | Bullone (DIN 912)                | Boulonner (DIN 912)          | Atornillar (DIN 912)          |
| 23 Antriebsritzel                 | Driving Pinion            | Ingresso Pignone                 | Engrenage Z1                 | Piñón de entrada              |
| 24 Antriebsritzel (Mit Passfeder) | Driving Pinion (With Key) | Ingresso Pignone (Con chiavetta) | Engrenage Z1 (Avec clavette) | Piñón de entrada (Con clave)  |
| 25 Sicherungsring (DIN 471)       | Circlip (DIN 471)         | Anello di sicurezza (DIN 471)    | Circlip (DIN 471)            | Anillo de seguridad (DIN 471) |
| 26 Passfeder (DIN 6885)           | Key (DIN 6885)            | Chiavetta (DIN 6885)             | Clavette (DIN 6885)          | Clave (DIN 6885)              |

DE ALLGEMEINE TEILELISTE

EN GENERAL PART LIST

IT GENERALE ELENCO DELLE PARTI

FR GÉNÉRALE LA LISTE DES PIÈCES

ES LISTE DE PIEZAS EN GENERAL

**AF / F 301 ... 701 / 252 ... 902 / 253 ... 903 - B5**

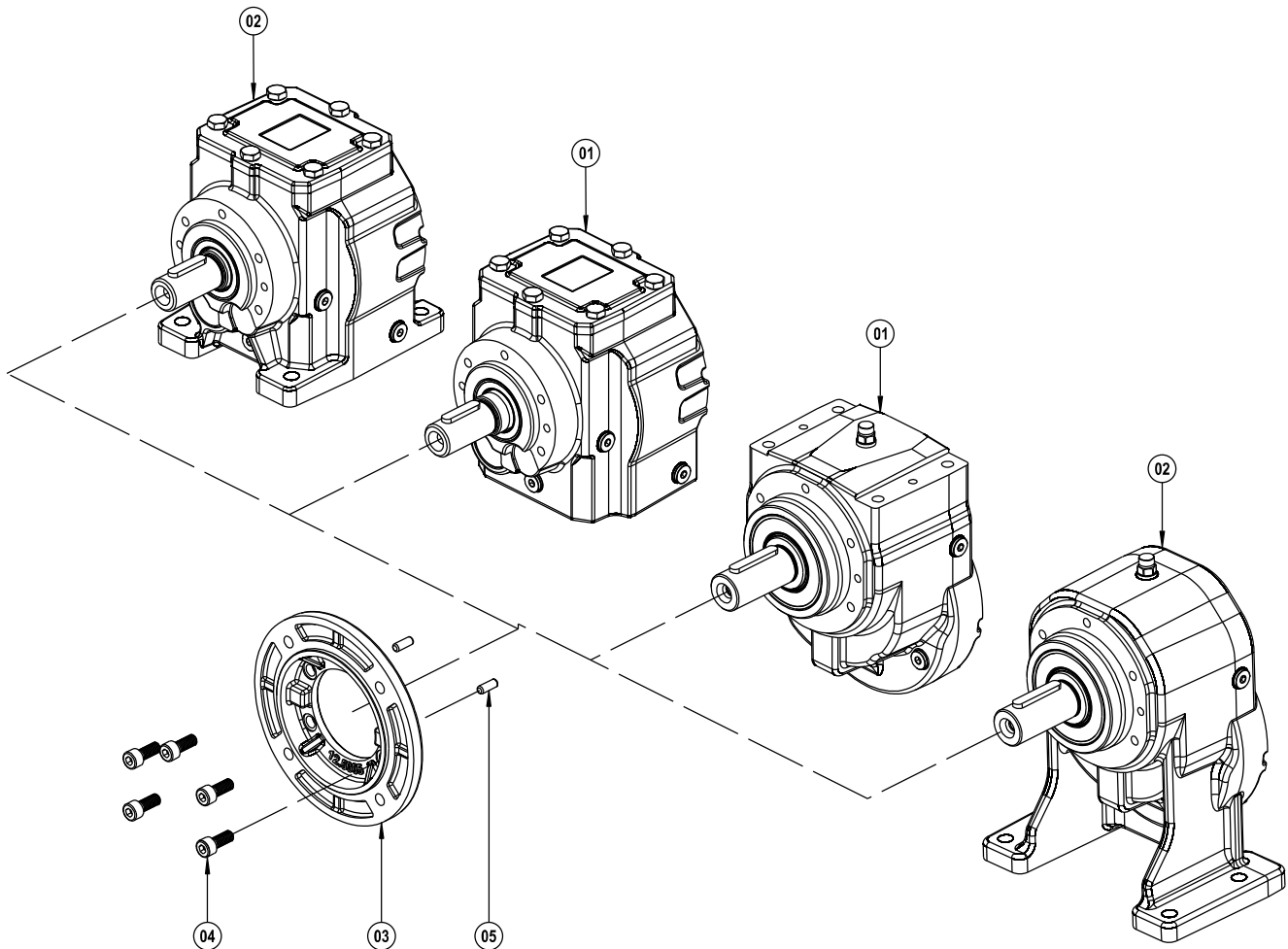

- 01 F Bausatz
- 02 AF Bausatz
- 03 B5 Abtriebsflansch
- 04 Verschrauben (DIN 912)
- 05 Bolzen

- F Kit
- AF Kit
- B5 Output Flange
- Bolt (DIN 912)
- Pin

- F Kit
- AF Kit
- B5 Flangia d'uscita
- Bullone (DIN 912)
- Pin

- F Kit
- AF Kit
- B5 Bride sortie
- Boulonner (DIN 912)
- Goupille

- F Kit
- AF Kit
- B5 Brida de solida
- Atornillar (DIN 912)
- Pasador